

Figure 1

AUTOFILL BIRDBATH PARTS

- Autofill Birdbath and Pedestal
- Assembled KozyFill Canister with Cap and Thumbscrew
- Three (3) pole sections
- 50 ft. of tubing
- Faucet wye with shutoffs
- Faucet-to-tubing Push-in Connector
- Fill Valve Nut
- Cone Washer

AUTOFILL BIRDBATH SETUP

Please read all setup instructions before beginning.

Mount the Canister

1) Determine the location for the KozyFill Canister behind a tree or bush within approximately 20 feet of the birdbath. (Placing it farther away may result in slower filling.) When mounted, the Canister must be at the same level as the birdbath so that must be taken into account when choosing a location. Tap the pointed pole stake firmly into the ground at the desired point and insert the two pole sections such that the assembled pole is vertical. Also, unwind the tubing from the Canister and lay it in the sun to straighten.

2) Once the tubing has straightened in the sun, lay it along the ground for the Fill Line to the birdbath. Allow enough excess to extend up through the Pedestal to the Basin plus an additional 6-10 inches.

Attach the Fill Line

3) Thread the end of the Fill Line with the Flexible Tubing through the bottom of the birdbath Pedestal and out the top (see Figure 2) until it extends about 6 inches out the Pedestal.

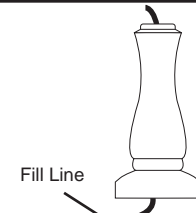

Figure 2

4) Firmly push the end of the Fill Line into the Push-in connector on the bottom of the Basin (Figure 3). It should push in approximately 1/2 inch. After insertion, pull back slightly on the tubing to make sure it is firmly seated.

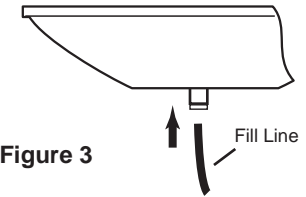

Figure 3

5) Place the basin on the Pedestal by aligning the metal plate on the bottom of the basin with the slots in the neck of the Pedestal. Rotate the basin clock-wise to lock it in place (Figure 4).

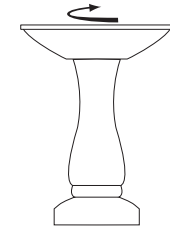

Figure 4

6) Return to the pole (from Step 1) and route the Fill Line so that it extends to the top of the pole. Cut the Fill Line at that point. (Save the excess tubing for Step 8.) Un-screw the Nut on the Fill Line Connector (Figure 5) and insert one end of the Fill Line through the Washer and Collar and then screw the Nut snugly back onto the connector.

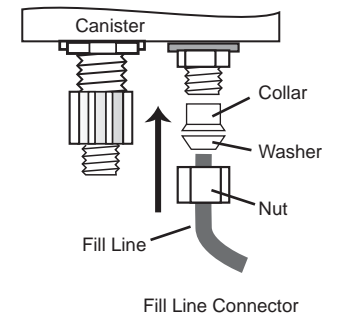

Figure 5

7) Slide the Canister onto the pole and lower it until the the Canister is lower than the rim of the birdbath. Tighten the Thumbscrew to hold the Canister in place (refer to Figure 1).

Connect the Supply Line

8) Roughen the surface of the last 2 inches of the Supply Line (the left-over tubing from Step 6) by rubbing it with sand-paper or steel wool and slide it through the Nut and the Cone Washer (see Figure 6) and insert it into the end of the Float Valve neck. (Make sure the Cone Washer is oriented as shown.) Tighten the Nut securely.

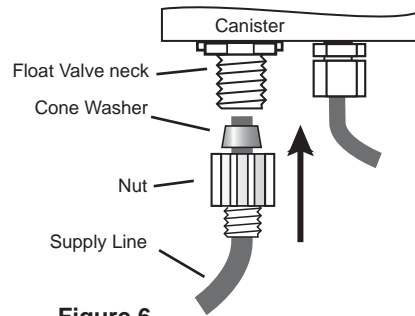

Figure 6

9) Attach the Wye to the outdoor faucet and screw the Push-in Connector to one side of the Wye (refer to Figure 7). Close the Wye Shut-offs.

10) Cut the Supply Line to length and insert the free end of the Supply Line into the Push-in Connector (refer to Figure 7). Make sure it is pushed in all the way.

NOTE: If not enough tubing is left for the Supply Line to reach from the Canister to the faucet, you may purchase additional semi-rigid, 3/8 inch O.D. tubing from a hardware store or home supply store.)

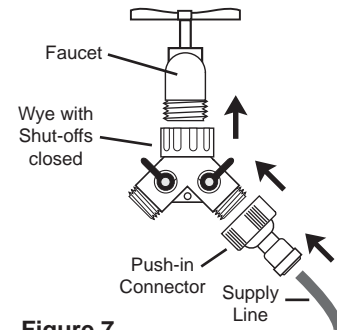

Figure 7

Adjust the Canister height

11) Slowly turn on the faucet (see Figure 8). Make sure that both Shut-offs on the Wye are fully closed.

12) Open the Shut-off on the Supply Line side of the Wye (see Figure 8) until you detect water starting to flow. **Make sure the pressure does not push the Supply Line out of the Float Valve connection.** If it does, roughen the end of the tubing with steel wool and then repeat Step 8 and tighten. Let the Canister fill with water until the Float Valve shuts off.

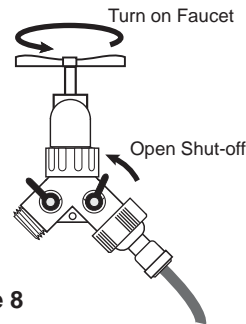

Figure 8

13) Loosen the Thumbscrew that holds the Canister to the pole and slowly slide the Canister up the pole until water *begins* to flow into the birdbath basin. Retighten the Thumbscrew to hold the Canister in place (Figure 9).

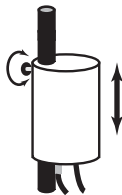

Figure 9

14) Wait until the water appears to stop flowing into the birdbath basin. This may take 10-30 minutes. Using a ruler, note how far the water level is below the desired water level (see Figure 10).

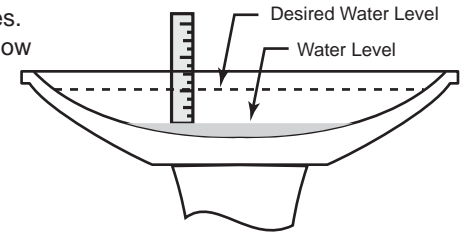

Figure 10

15) Loosen the Thumbscrew on the Canister and raise the Canister (see Figure 11) by the amount measured in Step 14. Tighten the Thumbscrew.

The KozyBird Resort is ready for operation. Water should begin flowing again into the basin when you complete Step 15. Let the basin fill and then check the system again for the proper water height. You may need to slightly adjust the Canister up or down to fine-tune the water depth.

16) Check the system for leaks. Make sure all the connections are snug and that the tubes are securely pushed into all connectors. If desired, the Fill Line may be buried at this time.

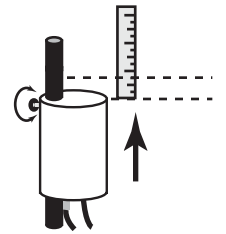

Figure 11

Operation

The water will flow slowly into the birdbath. Depending on the distance from the Canister to the birdbath, it may take a couple hours for the bath to fill initially. Afterwards, it will add water as it is used.

If the birdbath basin tilts or is removable, the water may be dumped and the birdbath will automatically refill with water.

Maintenance

The system should be inspected regularly to insure that the float is free to move and all connections are watertight. The pole should also be inspected to make sure it is secure. Be sure to clean the birdbath regularly.

Troubleshooting

If the connections leaks, make sure that the tubing at all push-in connectors is fully inserted. The tubing can often be pushed in another quarter inch after it first "stops" when inserted.

The adjustment screw on the Lever Arm inside the Canister may be used to make minor height adjustments. It is normal for the water level to vary slightly around the set point.

In some communities the water pressure builds up overnight which may cause the bath to fill slightly higher than normal or overflow on occasion. Adjust the level as needed.